

# BEE BRANCH CORRIDOR RESTORATION CURRENT CONCEPT

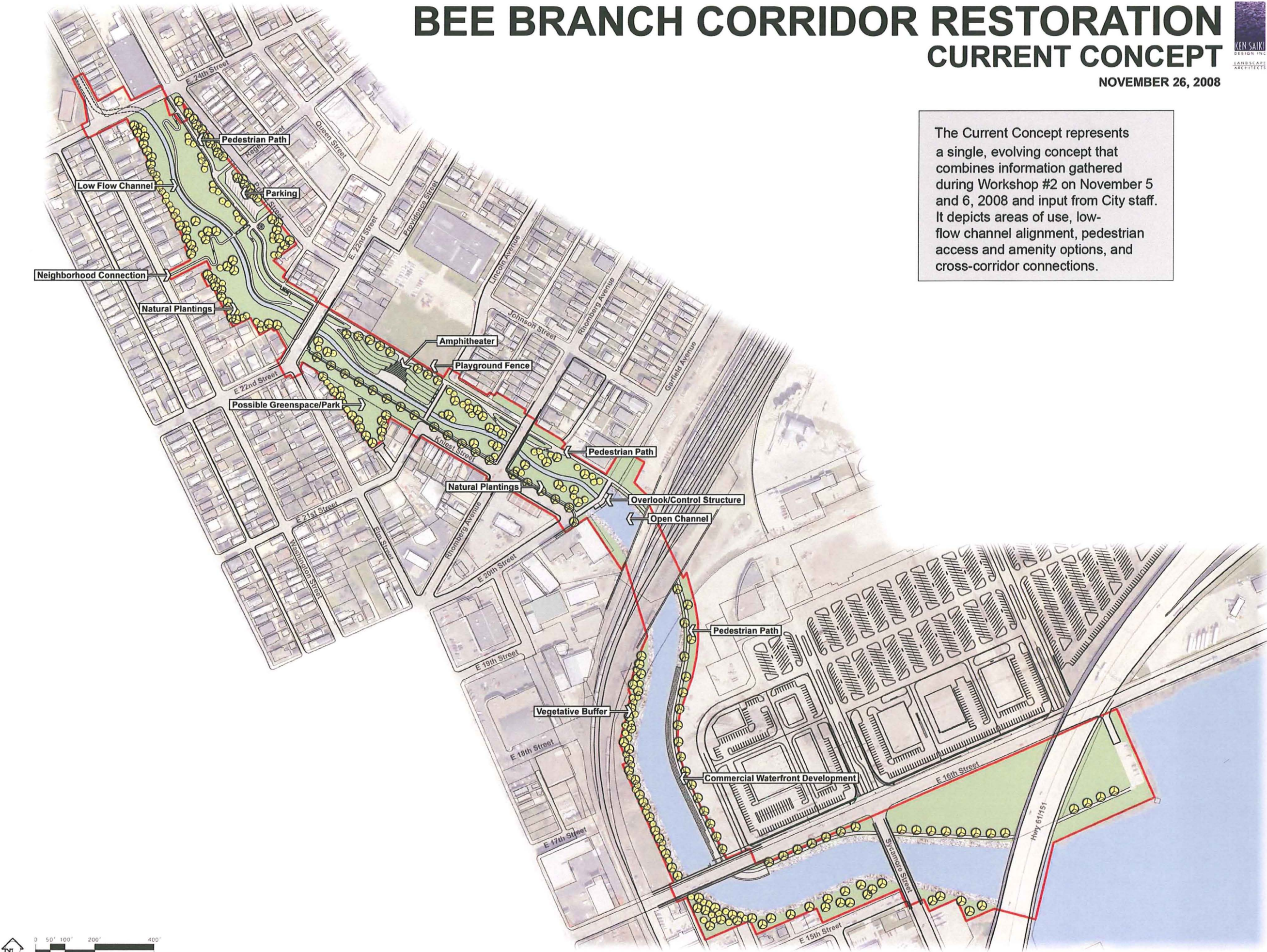

NOVEMBER 26, 2008

The Current Concept represents a single, evolving concept that combines information gathered during Workshop #2 on November 5 and 6, 2008 and input from City staff. It depicts areas of use, low-flow channel alignment, pedestrian access and amenity options, and cross-corridor connections.





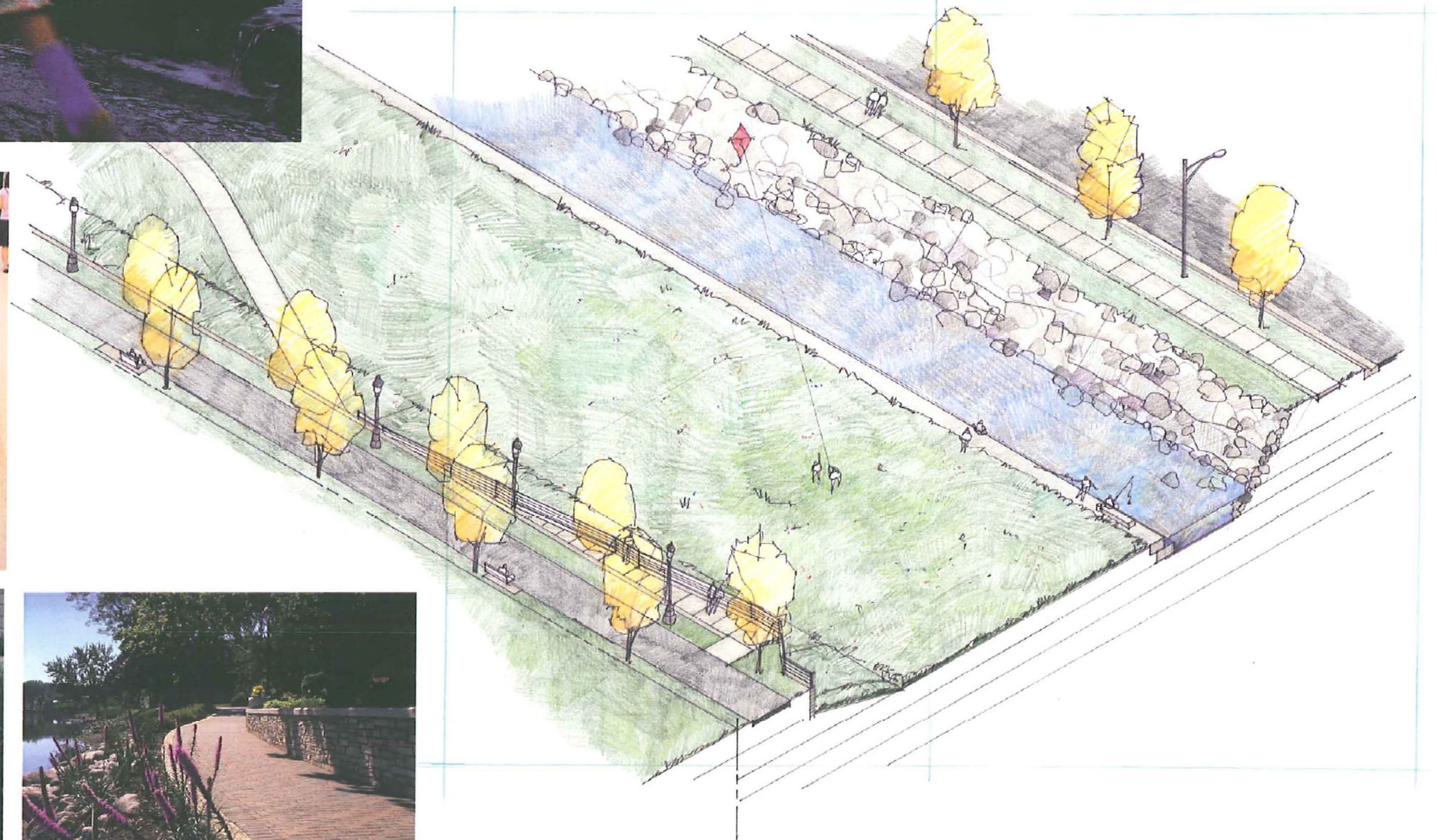
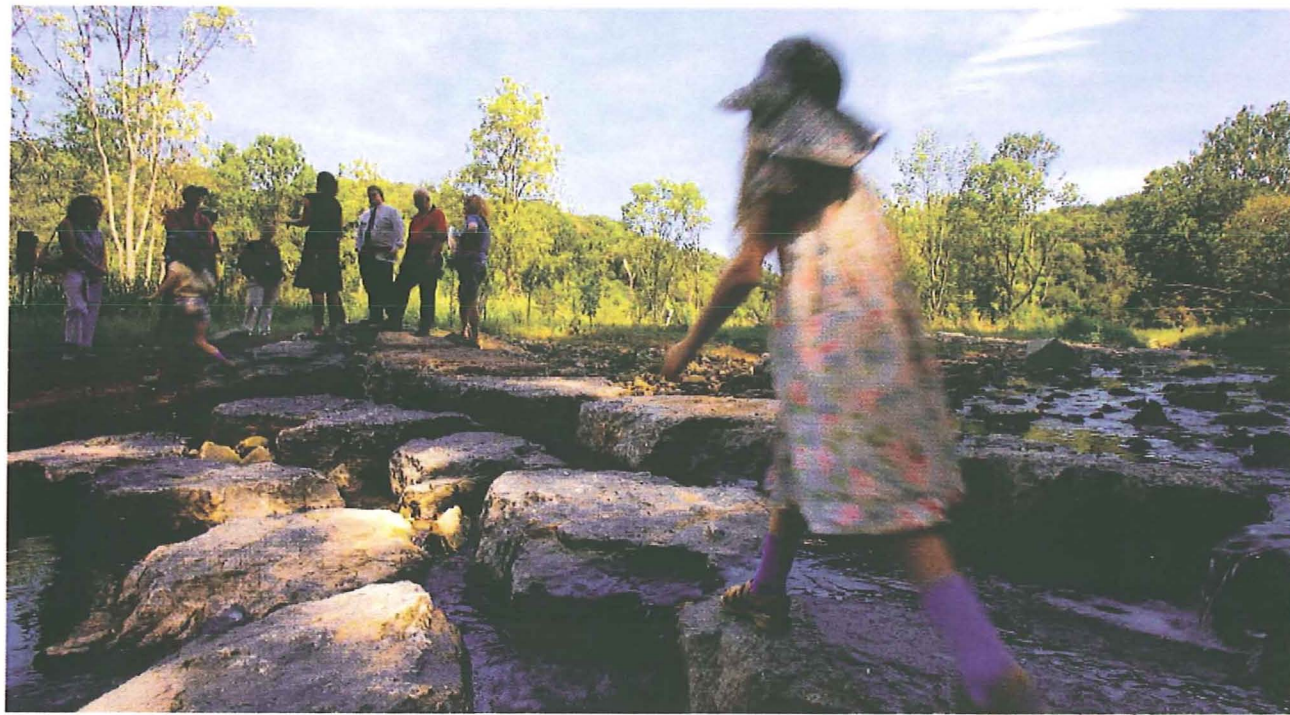

# BEE BRANCH CORRIDOR RESTORATION

## DEVELOPMENT IMAGES - 22ND TO 24TH STREET



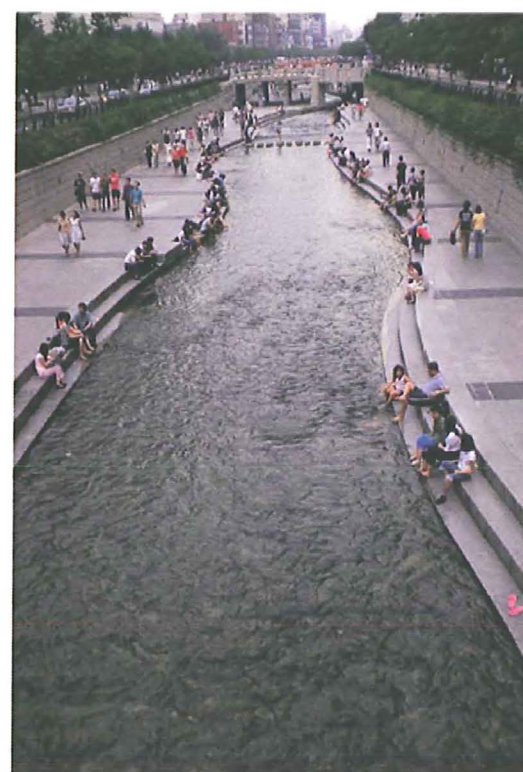
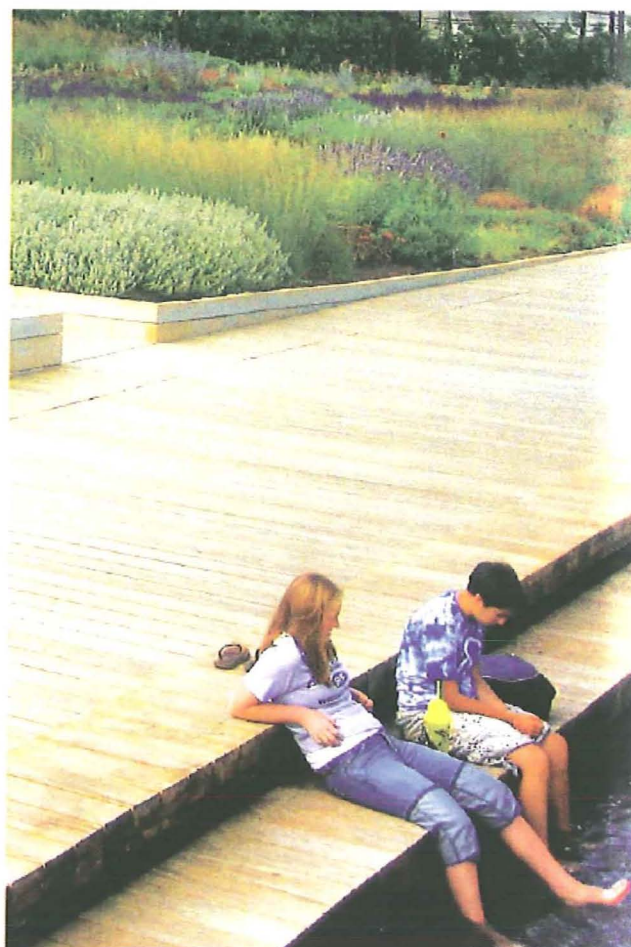
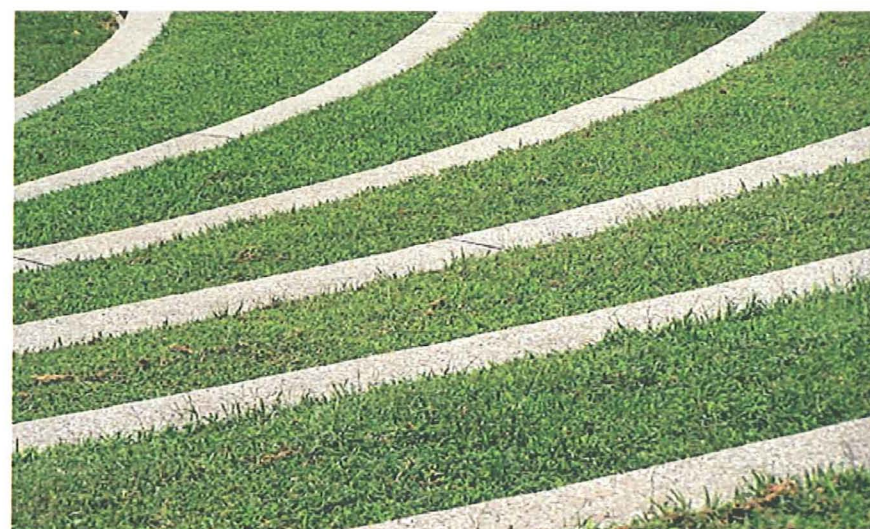

# BEE BRANCH CORRIDOR RESTORATION DEVELOPMENT IMAGES - 22ND TO LINCOLN STREET



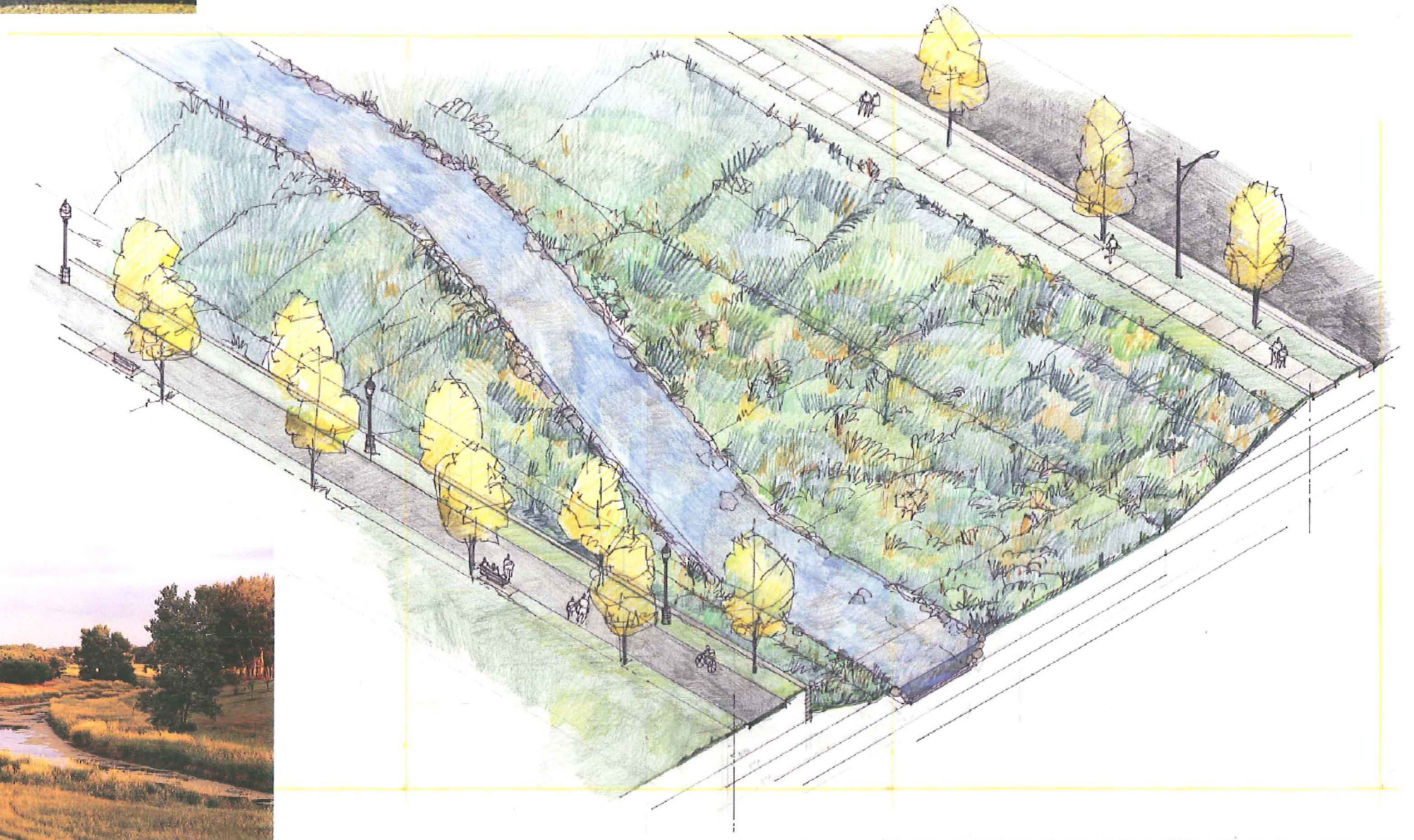
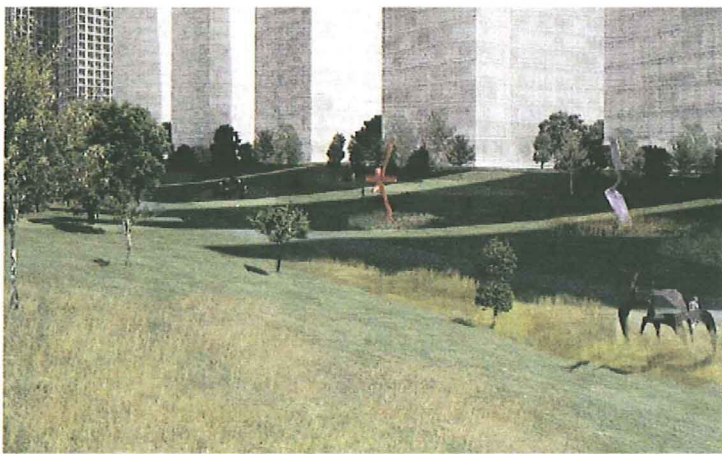

# BEE BRANCH CORRIDOR RESTORATION

## DEVELOPMENT IMAGES - RAILROAD TO LINCOLN STREET