

BEE BRANCH RESTORATION ALIGNMENT STUDY NEWSLETTER#5

April 2004



INTRODUCTION

You are receiving this newsletter because your home or business is located in an area that may be affected by flooding.

The Bee Branch Citizen Advisory Committee, or **BBCAC** for short, has been meeting since September of 2003. Appointed by the City Council, the goal of the committee is to help determine the best location to construct the drainage improvement to solve the flooding problems in your area.

BBCAC MEETING NOTES

At the fourth BBCAC meeting in March, the committee members continued to discuss options to solve the Bee Branch flooding problem. Although the total number is uncertain, property acquisitions will be necessary. A significant part of this study is to identify the homes and businesses impacted by the recommended flooding solution.

One alternative that the BBCAC is considering to solve the Bee Branch flooding problem is a combination of an underground sewer and an open channel. The underground portion would be built from 24th & Elm to the railroad tracks at Garfield. The open channel would be built from the railroad tracks at Garfield to the

16th Street detention basin. With a preliminary cost estimate that approaches \$42 million, this option would require the acquisition of approximately 74 properties.

The underground portion would consist of two pipes, each 10 feet high and between 28 and 42 feet wide. A 150-foot wide corridor would be required to construct the underground sewers. That is reason for the high number of property acquisitions.



To construct the underground alternative, a 150-foot wide area is required.

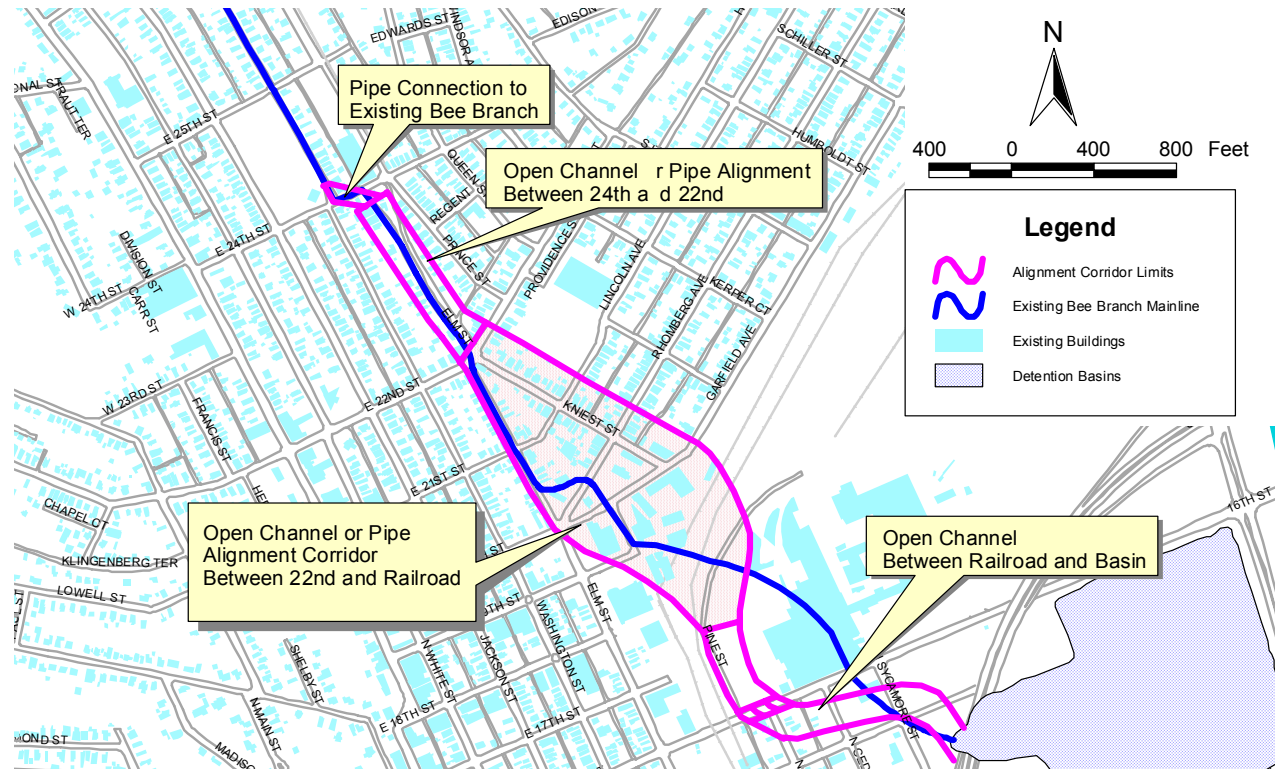

What is the Bee Branch Creek Alignment Study?

The purpose of the study is to determine where and what should be built to control stormwater in the North End along Washington, Elm, Prince, Jackson, and White Streets. Many of your neighbors have been appointed to serve on the Bee Branch Citizens Advisory Committee (BBCAC). Their goal is to represent your interests as they help determine the details of the solution to alleviate **flooding in the Bee Branch area.**

What would an open channel look like? The BBCAC has been asked this question. One option includes a smaller low-flow channel in the middle with an upper grassy overflow channel on each side.



ECRWSS
POSTAL CUSTOMER

50 West 13th Street
Dubuque, IA 52001-4864



PRSRT STD
US POSTAGE PAID
DUBUQUE, IOWA
PERMIT NO 136



Everyone is welcome to attend Bee Branch Citizen Advisory Committee (BBCAC) meetings to learn more about the Bee Branch flooding problem, potential solutions, and how the BBCAC works.

Upcoming BBCAC meetings are scheduled for 6:00 p.m. at Comiskey Park, for the following dates:

<u>DATE</u>	<u>MEETING TOPIC</u>
May 3, 2004:	Preferred Alternative
June TBA	Recommendations

What do you think?

A Bee Branch flooding display will be staffed at the upcoming **Neighborhood Resource Fair** sponsored by the North End Neighborhood Association. The event is to be held on Thursday, April 29 from 6 to 8 p.m. at Audubon School. **Come and bring your thoughts and questions.**

QUESTIONS OR INPUT

Questions or input can be directed to any of your neighbors on the BBCAC, including Charlie Winterwood (BBCAC Chair) at 588-2783.

Other Project Contacts:

Tony Zelinskas (WHKS) at 582-5481 or
Deron Muehring (City of Dubuque) at 589-4276.